

05/08/09

CONTRACT NO.: DA00300 WBS ELEMENT: 2017CPT.01.01.20081.1, ETC.

STATE OF NORTH CAROLINA
DIVISION OF HIGHWAYS

BERTIE COUNTY (NORTH)

LOCATION: MAP 1 SR 1342 FROM SR 1314 TO SR 1001
 MAP 2 SR 1240 FROM HERTFORD CO. LINE TO SR 1235
 MAP 3 SR 1341 FROM SR 1001 TO SR 1342
 MAP 4 SR 1217 FROM SR 1221 TO END

TYPE OF WORK: RESURFACING

STATE	STATE PROJECT REFERENCE NO.	SHEET NO.	TOTAL SHEETS
N.C.	2017CPT.01.01.20081.1, ETC.	1	
STATE PROJ. NO.	F.A. PROJ. NO.	DESCRIPTION	
2017CPT.01.01.20081.1		MAPS 1 - 4	

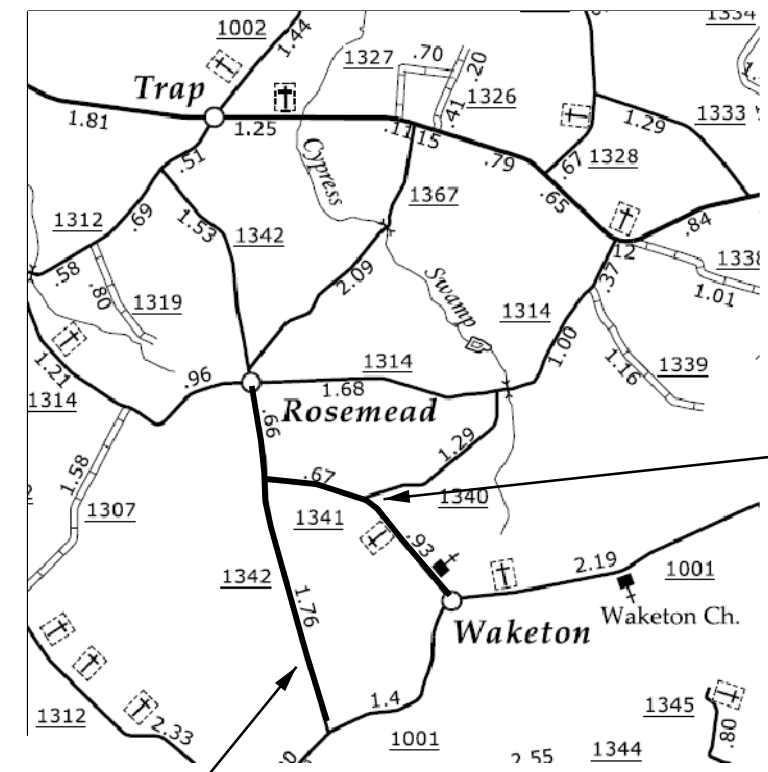

MAP 1

MAP 2

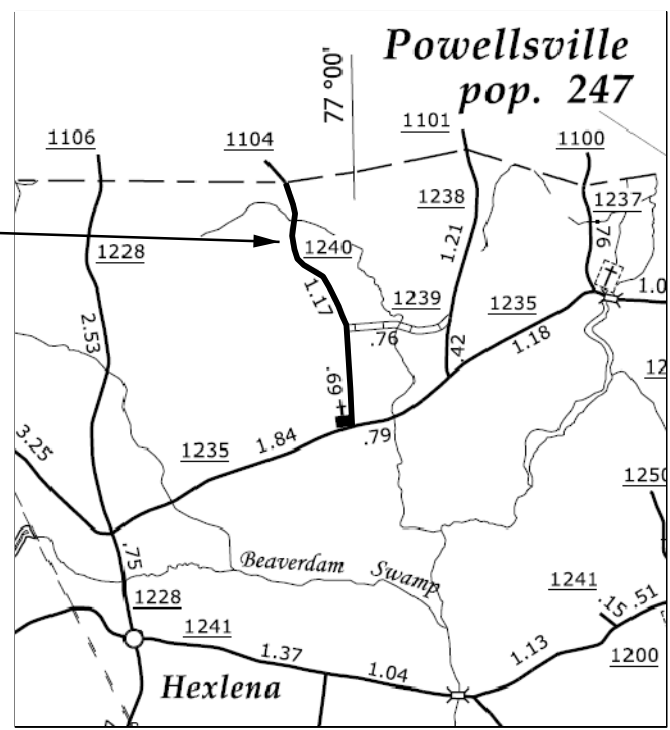

MAP 3

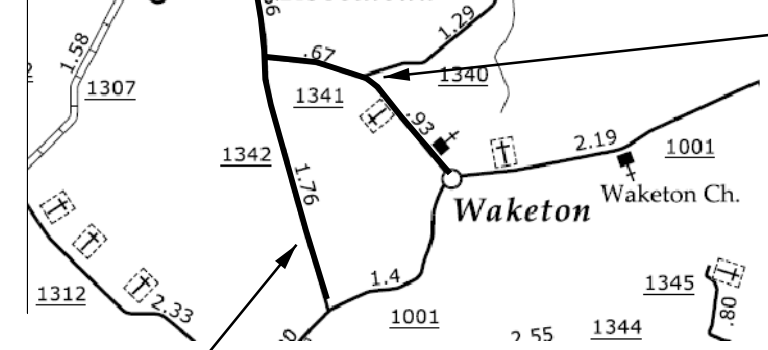

MAP 4

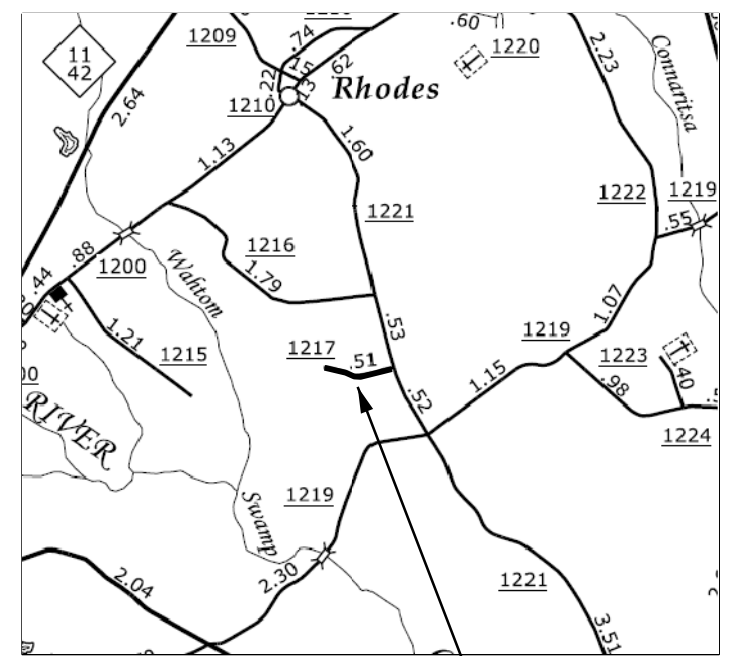

NTS

PROJECT LENGTH
LENGTH OF ROADWAY PROJECT MAP 1 = 2.42 MI.
LENGTH OF ROADWAY PROJECT MAP 2 = 1.86 MI.
LENGTH OF ROADWAY PROJECT MAP 3 = 1.57 MI.
LENGTH OF ROADWAY PROJECT MAP 4 = 0.50 MI.

Prepared In the Office of: DIVISION OF HIGHWAYS 113 Airport Dr., Edenton NC, 27932	
2012 STANDARD SPECIFICATIONS	
LETTING DATE:	W.B. HOBBS, P.E. DIVISION PROJECT MANAGER C.E. SLACHTA DIVISION PROPOSALS ENGINEER

DIVISION OF HIGHWAYS
STATE OF NORTH CAROLINA

05/08/99

CONTRACT NO. : DA00300 WBS ELEMENT: 2017CPT.01.01.20081.1, ETC.

STATE OF NORTH CAROLINA
DIVISION OF HIGHWAYS

HERTFORD COUNTY

LOCATION: MAP 9 SR 1316 FROM US 258 TO SR 1315
 MAP 10 SR 1100 FROM SR 1104 TO SR 1101
 MAP 11 SR 1152 FROM SR 1154 TO END PAVEMENT
 MAP 12 SR 1130 FROM SR 1108 TO NC 11
 MAP 13 SR 1113 FROM BERTIE CO. LINE TO NC 305
 MAP 14 SR 1133 FROM SR 1108 TO END
 MAP 15 SR 1104 FROM SR 1106 TO BERTIE CO. LINE
 MAP 16 SR 1215 FROM SR 1130 TO SR 1213
TYPE OF WORK: WIDENING & RESURFACING

STATE	STATE PROJECT REFERENCE NO.	SHEET NO.	TOTAL SHEETS
N.C.	2017CPT.01.01.20081.1, ETC.	3	
STATE PROJ. NO.	F.A. PROJ. NO.	DESCRIPTION	
2017CPT.01.01.20461.1		MAP 9 - 16	

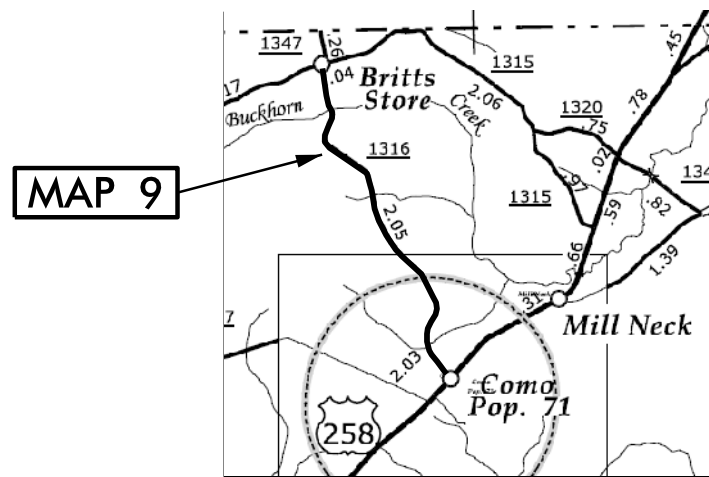

MAP 9

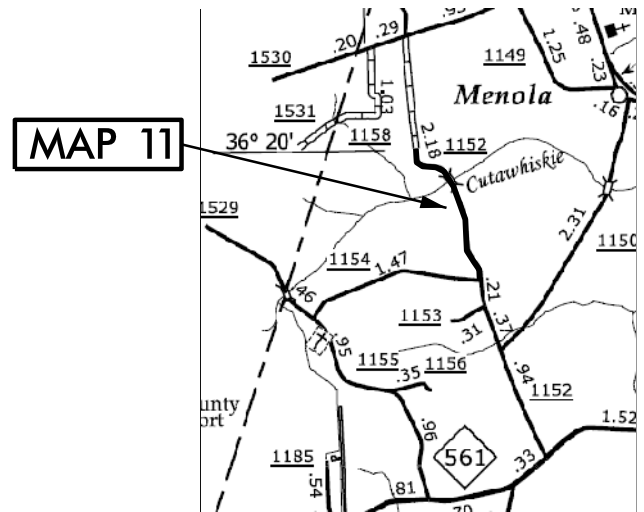

MAP 11

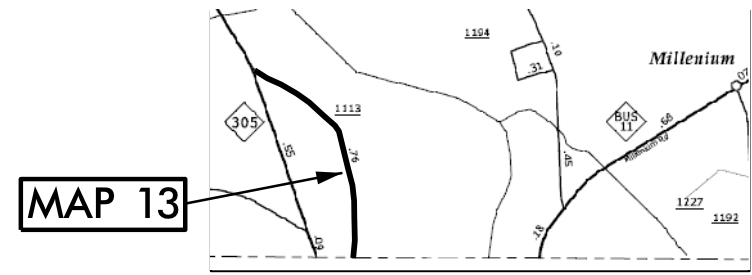

MAP 13

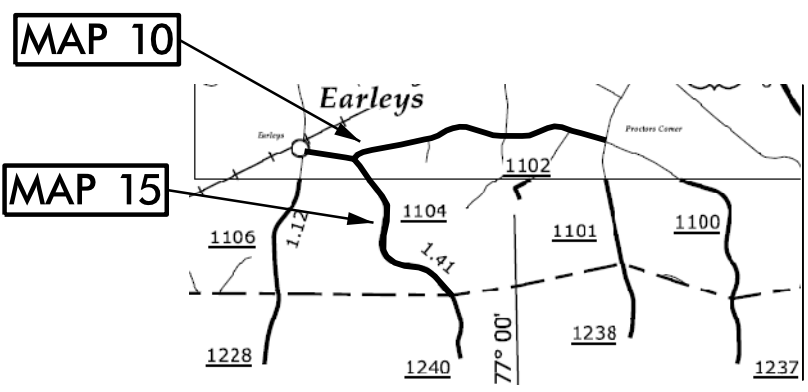

MAP 10

MAP 15

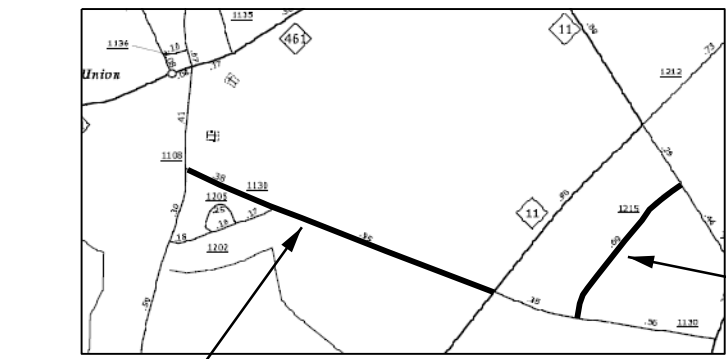

MAP 12

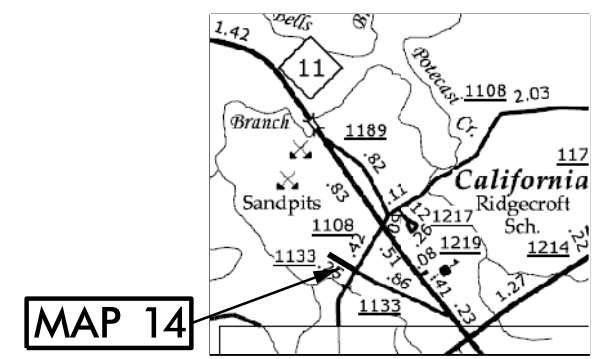

MAP 14

MAP 16

NTS

PROJECT LENGTH

LENGTH OF ROADWAY PROJECT MAP 9	= 2.93 MI.
LENGTH OF ROADWAY PROJECT MAP 10	= 1.92 MI.
LENGTH OF ROADWAY PROJECT MAP 11	= 1.21 MI.
LENGTH OF ROADWAY PROJECT MAP 12	= 1.28 MI.
LENGTH OF ROADWAY PROJECT MAP 13	= 0.70 MI.
LENGTH OF ROADWAY PROJECT MAP 14	= 0.33 MI.
LENGTH OF ROADWAY PROJECT MAP 15	= 1.76 MI.
LENGTH OF ROADWAY PROJECT MAP 16	= 0.67 MI.

Prepared In the Office of:
DIVISION OF HIGHWAYS
 113 Airport Dr., Edenton NC, 27932

2012 STANDARD SPECIFICATIONS	
LETTING DATE:	W.B. HOBBS, P.E. DIVISION PROJECT MANAGER
	C.E. SLACHTA DIVISION PROPOSALS ENGINEER

DIVISION OF HIGHWAYS
 STATE OF NORTH CAROLINA



P A V E M E N T S C H E D U L E

C1	PROP. APPROX. 1.25" ASPHALT CONCRETE SURFACE COURSE, TYPE SF9.5A, AT AN AVERAGE RATE OF 137.5 LBS. PER SQ. YD.
U	EXISTING PAVEMENT.

PROJECT REFERENCE NO.	SHEET NO.
2017CPT.01.01.20081.1, ETC.	4

NOTES:

*ALL PAVED S.R. ROADS TO BE RESURFACED TO THE ENDS OF THE RADII., OR AS DIRECTED BY THE ENGINEER

*EDGES, PAVEMENT WIDENING, INTERSECTIONS, AND BRIDGE FLARES ARE INCLUDED IN THE SUMMARY OF QUANTITIES

*SHOULDER RECONSTRUCTION TO BE PERFORMED BY OTHERS

*PAVEMENT MARKINGS TO BE PERFORMED BY OTHERS

*WARM MIX ASPHALT REQUIRED ON MAP 6 (SR 1521).

*BRIDGE #59 ON MAP 11 (SR 1152) SHALL BE MILLED 1.25" AND RESURFACED WITH 1.25" OF ASPHALT.

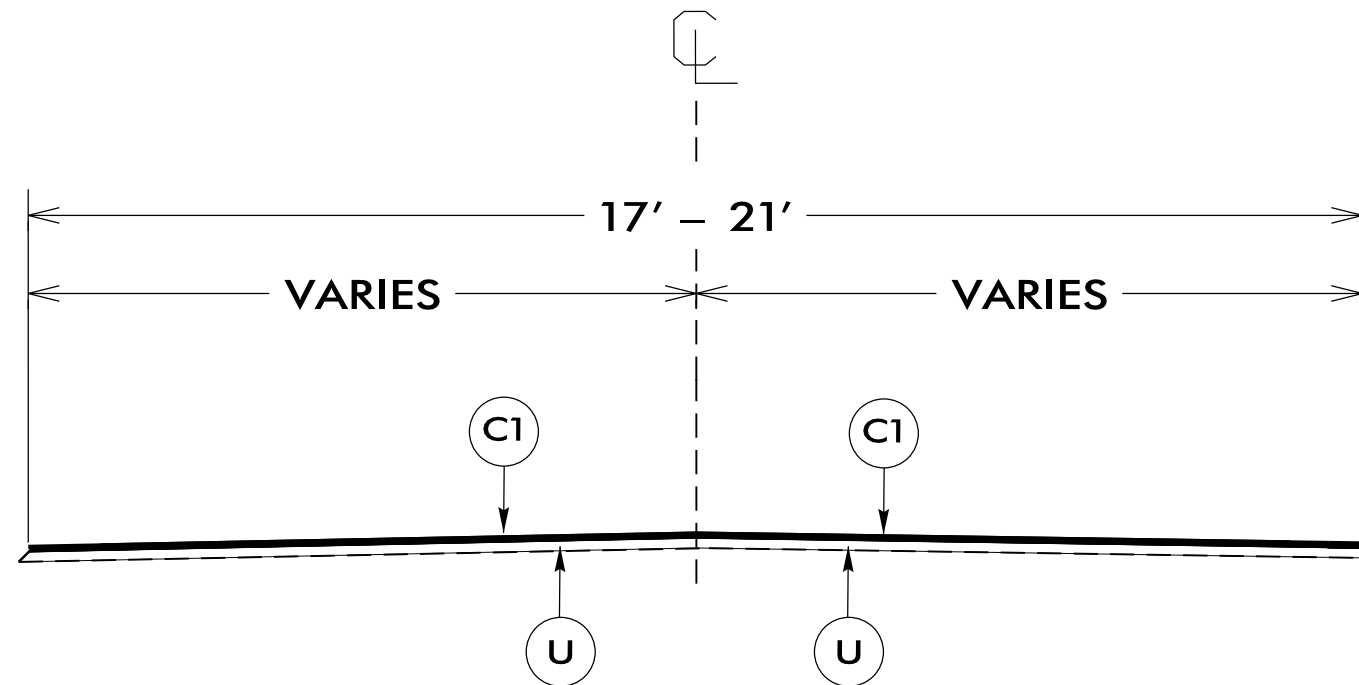

TYPICAL SECTION NO. 1

USE WITH MAPS 1, 3-4, 6-8, 10-14, & 16

NTS

06-DEC-2016 15:03 C:\Users\res\Documents\Projects\Division Project Working Files\District Two\DA00300 Herford & Bertie Resurfacing (2017-2018)\1 Pre-Bid Documents\Sht 1 - 6 DA00300 Plans.dgn

PAVEMENT SCHEDULE

C2	PROP. APPROX. 1.5" ASPHALT CONCRETE SURFACE COURSE, TYPE S9.5B, AT AN AVERAGE RATE OF 168 LBS. PER SQ. YD.
U	EXISTING PAVEMENT.

NOTES:

- *ALL PAVED S.R. ROADS TO BE RESURFACED TO THE ENDS OF THE RADII., OR AS DIRECTED BY THE ENGINEER
- *EDGES, PAVEMENT WIDENING, INTERSECTIONS, AND BRIDGE FLARES ARE INCLUDED IN THE SUMMARY OF QUANTITIES
- *SHOULDER RECONSTRUCTION TO BE PERFORMED BY OTHERS
- *PAVEMENT MARKINGS TO BE PERFORMED BY OTHERS

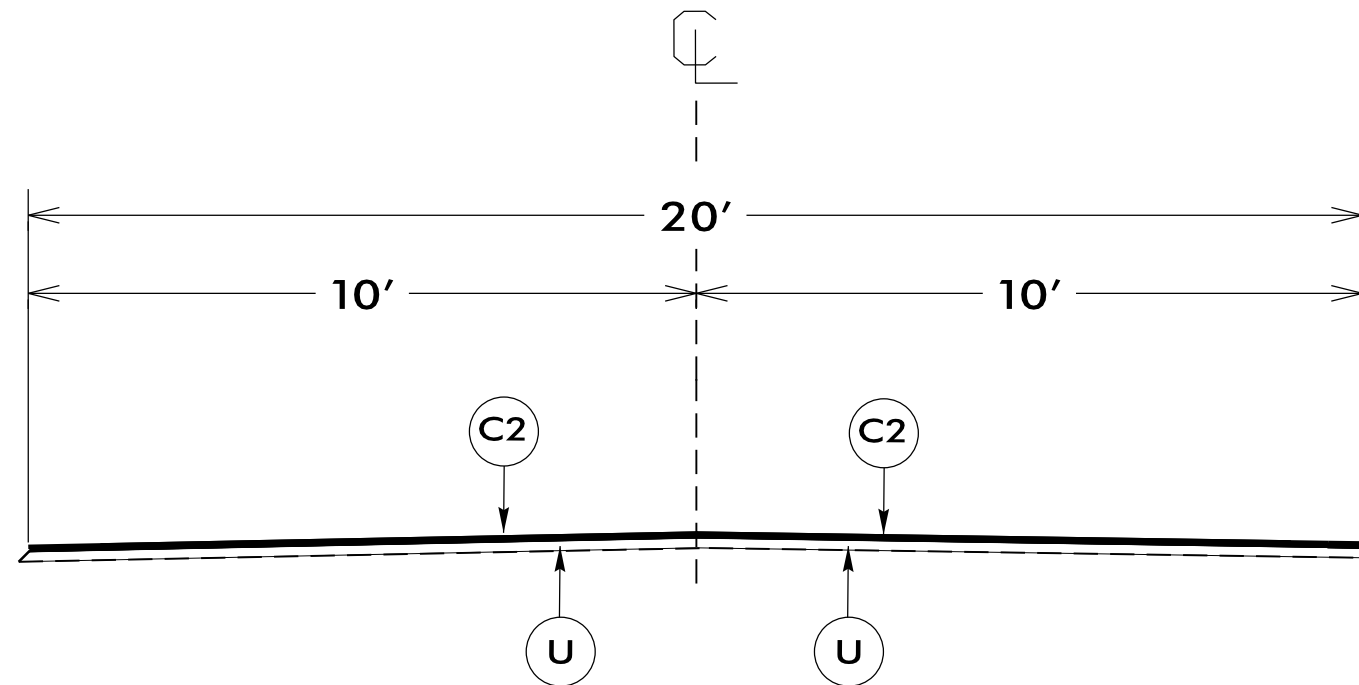

TYPICAL SECTION NO. 2

USE WITH MAP 5

NTS

P A V E M E N T S C H E D U L E

C1	PROP. APPROX. 1.25" ASPHALT CONCRETE SURFACE COURSE, TYPE SF9.5A, AT AN AVERAGE RATE OF 137.5 LBS. PER SQ. YD.
E	PROP. APPROX. 5.5" ASPHALT CONCRETE BASE COURSE, TYPE B25.0B AT AN AVERAGE RATE OF 627 LBS. PER SQ. YD.
U	EXISTING PAVEMENT.

PROJECT REFERENCE NO.	SHEET NO.
2016CPT.01.05.20081.1, ETC.	6

NOTES:

- *ALL PAVED S.R. ROADS TO BE RESURFACED TO THE ENDS OF THE RADI., OR AS DIRECTED BY THE ENGINEER
- *EDGES, PAVEMENT WIDENING, INTERSECTIONS, AND BRIDGE FLARES ARE INCLUDED IN THE TABLE OF QUANTITIES
- *SHOULDER RECONSTRUCTION TO BE PERFORMED BY OTHERS
- *PAVEMENT MARKINGS TO BE PERFORMED BY OTHERS
- *WARM MIX ASPHALT REQUIRED ON MAP 2 (SR 1240)

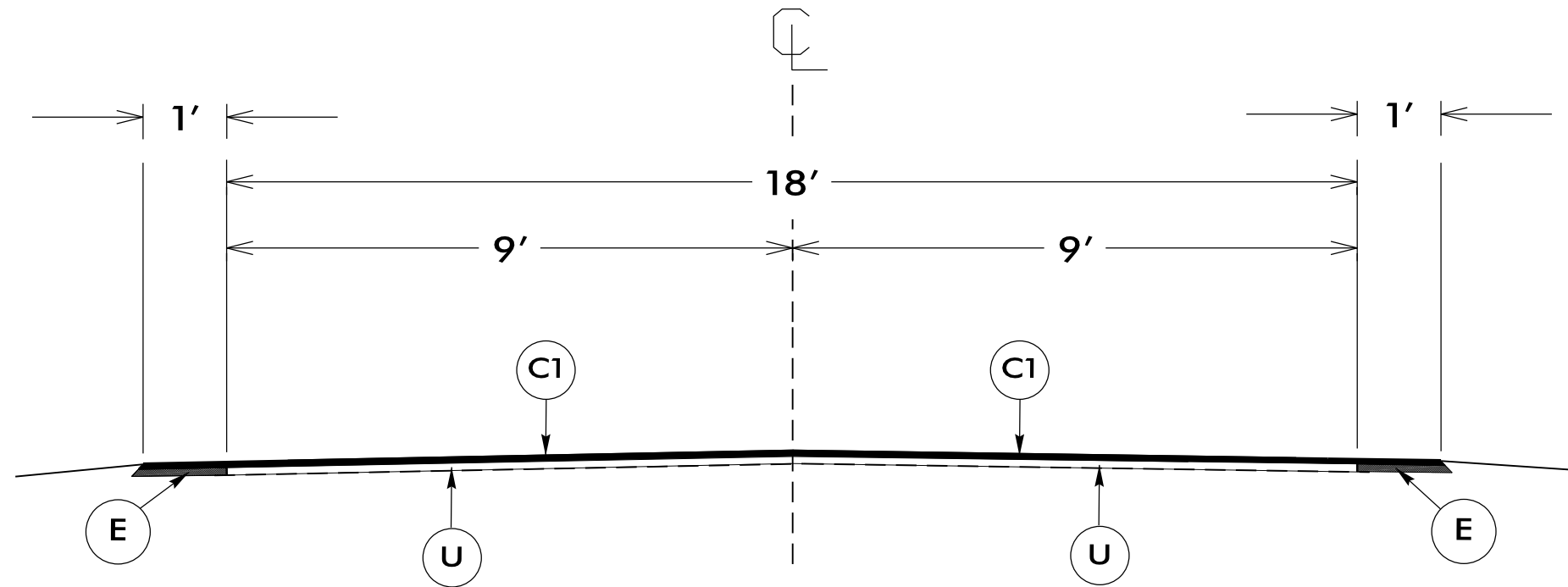

TYPICAL SECTION NO.3

USE WITH MAP 2, 9, & 15

NTS

05-DEC-2016 15:06 C:\Users\Alesia\OneDrive\Documents\Projects\2016\2016-2017\11\Pre-Bid Documents\Sht 1 - 6 DA000300 Plans.dgn PROJECT WORKING FILES\District Two\DA000300 Herford & Bertie Resurfacing (2017-2018)\11 Pre-Bid Documents\Sht 1 - 6 DA000300 Plans.dgn

PROJECT NO.	SHEET NO.	TOTAL NO.
2017CPT.01.01.20081.1, ETC.	7	

SUMMARY OF QUANTITIES

PROJECT NO	COUNTY	MAP NO	ROUTE	DESCRIPTION	TYP NO	LANES	LANE TYPE	FINAL SURFACE TESTING REQUIRED	WARM MIX ASPHALT REQUIRED	LENGTH MI	WIDTH FT	MOBILIZATION LS	INCIDENTAL STONE BASE TN	INCIDENTAL MILLING SY	BASE COURSE, B25.0B TONS	SURFACE COURSE, S9.5B TONS	SURFACE COURSE, SF9.5A TONS	ASPHALT BINDER FOR PLANT MIX TONS	WORK ZONE ADVANCE/GENERAL WARNING SIGNING SF	TEMPORARY TRAFFIC CONTROL LS
2017CPT.01.01.20081.1	Bertie (North)	1	SR 1342	FROM SR 1314 TO SR 1001	1	2	2WU	NO	NO	2.42	18	1					1,853	124	112	1
2017CPT.01.01.20081.1	Bertie (North)	2	SR 1240	FROM HERTFORD CO. LINE TO SR 1235	3	2	2WU	NO	YES	1.86	18	*	35		685		1,541	133	80	*
2017CPT.01.01.20081.1	Bertie (North)	3	SR 1341	FROM SR 1001 TO SR 1342	1	2	2WU	NO	NO	1.57	20	*					1,324	89	112	*
2017CPT.01.01.20081.1	Bertie (North)	4	SR 1217	FROM SR 1221 TO END	1	2	2WU	NO	NO	0.50	18	*					376	25	56	*
2017CPT.01.01.20081.1	Bertie (South)	5	SR 1260	FROM SR 1112 TO SR 1257	2	2	2WU	NO	NO	2.80	20	*		60		2,848		171	112	*
2017CPT.01.01.20081.1	Bertie (South)	6	SR 1521	FROM US13/17 TO SR 1523	1	2	2WU	NO	YES	2.89	21	*					2,565	172	112	*
2017CPT.01.01.20081.1	Bertie (South)	7	SR 1526	FROM US 13/17 TO END	1	2	2WU	NO	NO	0.41	17	*					291	20	56	*
2017CPT.01.01.20081.1	Bertie (South)	8	SR 1108	FROM NC 11 TO BRIDGE #85	1	2	2WU	NO	NO	1.99	21	*					1,754	118	112	*
2017CPT.01.01.20461.1	Hertford	9	SR 1316	FROM US 258 TO SR 1315	3	2	2WU	NO	NO	2.93	18	*	35		1,075		2,419	209	128	*
2017CPT.01.01.20461.1	Hertford	10	SR 1100	FROM SR 1104 TO SR 1101	1	2	2WU	NO	NO	1.92	21	*					1,718	115	72	*
2017CPT.01.01.20461.1	Hertford	11	SR 1152	FROM SR 1154 TO END PVMT	1	2	2WU	NO	NO	1.21	20	*		200			1,017	68	80	*
2017CPT.01.01.20461.1	Hertford	12	SR 1130	FROM SR 1108 TO NC 11	1	2	2WU	NO	NO	1.28	21	*					1,168	78	128	*
2017CPT.01.01.20461.1	Hertford	13	SR 1113	FROM BERTIE CL TO NC 305	1	2	2WU	NO	NO	0.70	19	*					556	37	104	*
2017CPT.01.01.20461.1	Hertford	14	SR 1133	FROM SR 1108 TO END	1	2	2WU	NO	NO	0.33	18	*					241	16	80	*
2017CPT.01.01.20461.1	Hertford	15	SR 1104	FROM SR 1106 TO BERTIE CO. LINE	3	2	2WU	NO	NO	1.76	19	*	28		650		1,492	129	80	*
2017CPT.01.01.20461.1	Hertford	16	SR 1215	FROM SR 1130 TO SR 1213	1	2	2WU	NO	NO	0.67	20	*					563	38	104	*
GRAND TOTAL										25.24		1	98	260	2,410	2,848	18,878	1,542	1,528	1

NOTES:

- 1) DETAIL DOES NOT APPLY TO OGAFB AND ULTRA-THIN BONDED WEARING COURSE.
- 2) BACKFILL SHOULDER WITH APPROVED MATERIAL.
- 3) THE SHOULDER WEDGE DEVICE MAY BE DISENGAGED AT PAVED DRIVEWAYS, SIDE STREETS, HIGH SHOULDERS, AND OTHER LOCATIONS NOT FEASIBLE TO CONSTRUCT AS APPROVED BY THE ENGINEER.

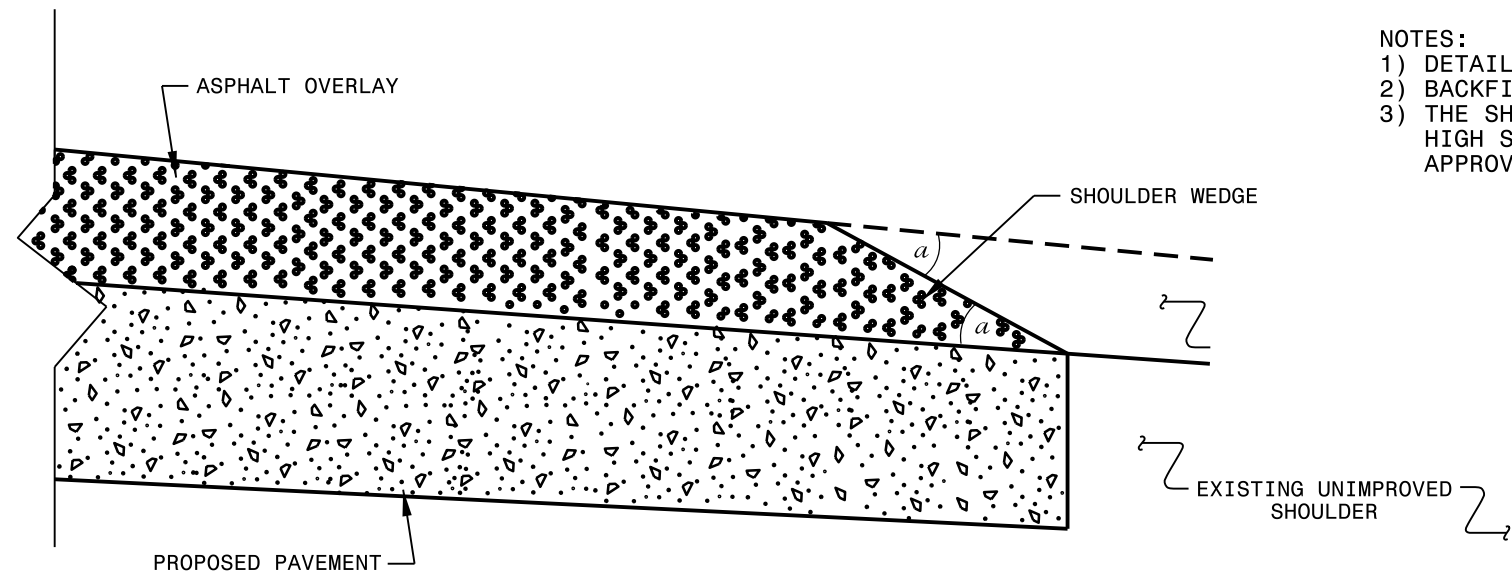

SHOULDER WEDGE DETAIL
(Resurfacing Projects w/ Widening or
with Existing Paved Shoulder having no dropoffs)

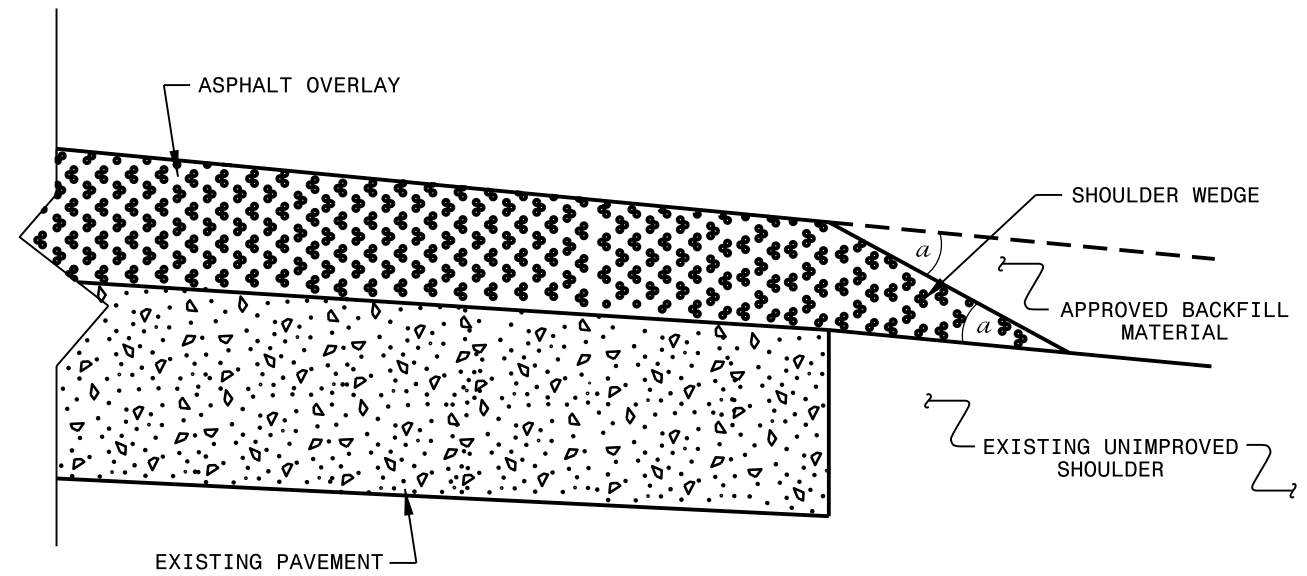

SHOULDER WEDGE DETAIL
(Resurfacing Projects w/ NO Widening)

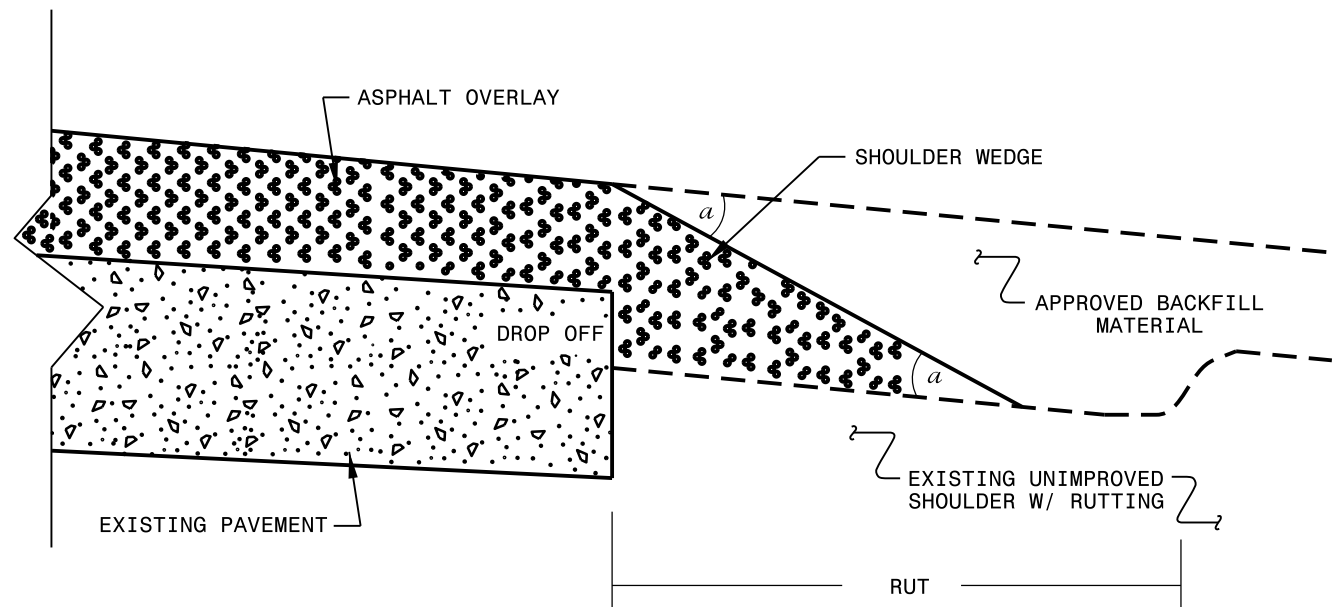

SHOULDER WEDGE DETAIL
(Resurfacing Adjacent to
Rutted Shoulder)

- SHOULDER WEDGE ANGLE = 30°

CONTRACT STANDARDS AND DEVELOPMENT UNIT			
Office 919-707-6950		FAX 919-250-4119	
SHOULDER WEDGE DETAILS			
ORIGINAL BY: T.SPELL	DATE: 7-19-11		
MODIFIED BY:	DATE: 2/2/16		
CHECKED BY:	DATE:		
FILE SPEC.: susr/details/stand/shoulderwedgedetail.dgn			

SYSTEMS DESIGN
USER NAME

SIGNING FOR RESURFACING PROJECTS

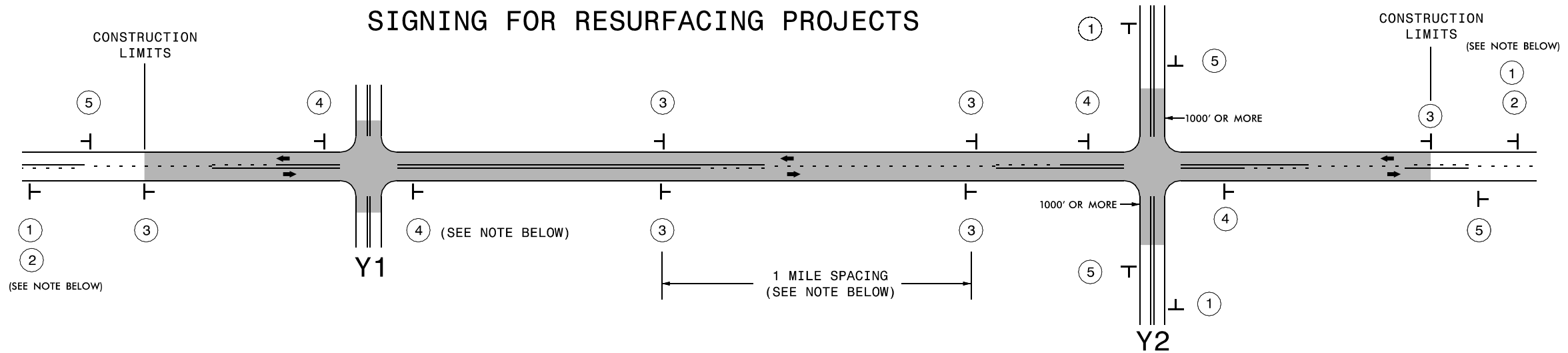

LEGEND	
T	STATIONARY SIGN
←	DIRECTION OF TRAFFIC FLOW

MAINLINE (-L-) SIGNING

-Y- LINE SIGNING

SIGNING NOTES AND PLACEMENT PER DIRECTION	MAINLINE (-L-) SIGNING		-Y- LINE SIGNING	
	①	 W20-1 48" X 48"	PLACE 1000' PRIOR TO BEGINNING OF CONSTRUCTION LIMITS. ONLY USED ON -Y- LINES IF RESURFACING LIMITS EXTEND 1000' ALONG -Y- LINE.	<p>NO REQUIRED STATIONARY SIGNING FOR THE FOLLOWING -Y- LINE CONDITIONS:</p> <ol style="list-style-type: none"> 1) LESS THAN 1000' OF RESURFACING ALONG -Y- LINE 2) SUBDIVISION ROADS 3) DEAD END ROADS <p>WHEN PAVING/CONSTRUCTION ACTIVITIES PROCEED ACROSS AN UNSIGNED -Y- LINE, ADVANCE WARNING PORTABLE SIGNS SHALL BE USED ALONG THE -Y- LINE AS SHOWN BELOW. REMOVE UPON COMPLETION OF WORK.</p> <div style="display: flex; justify-content: space-around;"> <div style="text-align: center;"> W20-1 48" X 48" </div> <div style="text-align: center;"> W20-7 A 48" X 48" </div> </div> <p>PLACED 500' IN ADVANCE OF FLAGGER. PLACED 250' IN ADVANCE OF FLAGGER.</p>
	②	 W7-3aP 24" X 18"	#2 SIGN ONLY USED WHEN RESURFACING LIMITS ARE 2 OR MORE MILES IN LENGTH. ROUND UP TO NEXT WHOLE NUMBER. (NO FRACTIONAL OR DECIMAL NUMBERS)	
	③	 SP 13107 48" X 48"	PLACE INITIALLY AT THE CONSTRUCTION LIMITS AND SPACED 1 MILE APART THEREAFTER. IF NO -Y- LINES EXIST, PLACE 2ND SET 1/2 MILE FROM THE CONSTRUCTION LIMITS AND THEN SPACE 1 MILE THEREAFTER.	
	④	 SP 13106 48" X 48"	THESE ARE FOR -Y- LINES THAT ARE "THROUGH" ROADWAYS. DEAD END AND SUBDIVISION ROADS ARE NOT "THROUGH" ROADWAYS. INSTALL 500' +/- FROM EACH -Y- LINE APPROACH AS SHOWN ABOVE. FOR MULTIPLE -Y- LINES THAT ARE SEPARATED BY 0.25 MILES OR LESS, TREAT AS A SINGLE UNIT AND INSTALL WITHIN 500' OF EACH APPROACH. A MAXIMUM OF 2 SIGN SETS PER MILE. DO NOT INSTALL WHEN -Y- LINES ARE WITHIN 0.5 MILES FROM "END ROAD WORK" SIGN.	
⑤	 G20-2 A 48" X 24"	PLACE 500' FOLLOWING THE END OF CONSTRUCTION LIMITS.		

8/8/2013
 S:\T\U\WZTC\Resurfacing\2013Documents\New_Pr ocedures_05_09_2013\Resurfacing_AdvWarn_2Ln.dgn
 User:frmgarr.ett

DIVISION OF HIGHWAYS
STATE OF NORTH CAROLINA
DEPARTMENT OF TRANSPORTATION
WORK ZONE TRAFFIC CONTROL

**RESURFACING
ADVANCE WARNING SIGNS
FOR
RURAL AND SUBURBAN
2 LANE ROADWAYS**